

Events AT THE **TWA HOTEL**



***“If anything can bring
glamour back to JFK airport,
it’s the TWA Hotel.”***

— VOGUE

***“They don’t make them
like this anymore, and
they never will again.”***

— THE WALL STREET JOURNAL

***“The coolest hotel in
New York City.”***

— TIME

***“You may want to stay
at Kennedy Airport.
By choice. Seriously.”***

— THE NEW YORK TIMES

***“King of the
airport hotels.”***

— THE POINTS GUY



1962



TODAY

A Landmark Reborn

Designed by world renowned architect Eero Saarinen and opened in 1962, the TWA Flight Center was built for Trans World Airlines (TWA) by Howard Hughes to represent the era's excitement of travel. The TWA Flight Center was designated a New York City landmark in 1994 and, after its 2001 closure, was listed on the National and New York State Registers of Historic Places in 2005.

Saarinen's masterpiece has taken flight once again as the heart of the TWA Hotel. Two hotel wings, designed to reflect and defer to the landmark, sit behind the historic building.



The Solari board in The Sunken Lounge



Guestroom hallway



The 1962 living room exhibit

Hotel Highlights

The TWA Hotel features 512 ultra-quiet guestrooms with exhilarating views of JFK's runways and the TWA Flight Center plus:

- **50,000 square feet of meeting and event space** that can host up to 1,600 people
- **Celebrated chef Jean-Georges Vongerichten's Paris Café and Lisbon Lounge**, open for breakfast, lunch and dinner
- **The Sunken Lounge**, serving light bites as well as classic and signature cocktails
- **A rooftop infinity pool and observation deck** with views of runway 4L/22R and **The Pool Bar**, serving food and drinks
- **A Lockheed Constellation "Connie" L-1649A** transformed into a one-of-a-kind cocktail lounge
- **The world's largest hotel gym**: the state-of-the-art 10,000-square-foot TWA Fitness
- **Museum exhibits** including authentic TWA flight attendant uniforms, a recreation of a 1962 living room and reproductions of the offices of Howard Hughes and Eero Saarinen
- **A classic Solari split-flap message board** with original mechanical operation – manufactured in Udine, Italy – that can be customized with special messages for events and meetings

At the Center of Everything

The TWA Hotel is the only on-airport hotel at JFK Airport, which hosts 70+ airlines and serves more than 455,500 flights and 62 million passengers per year.

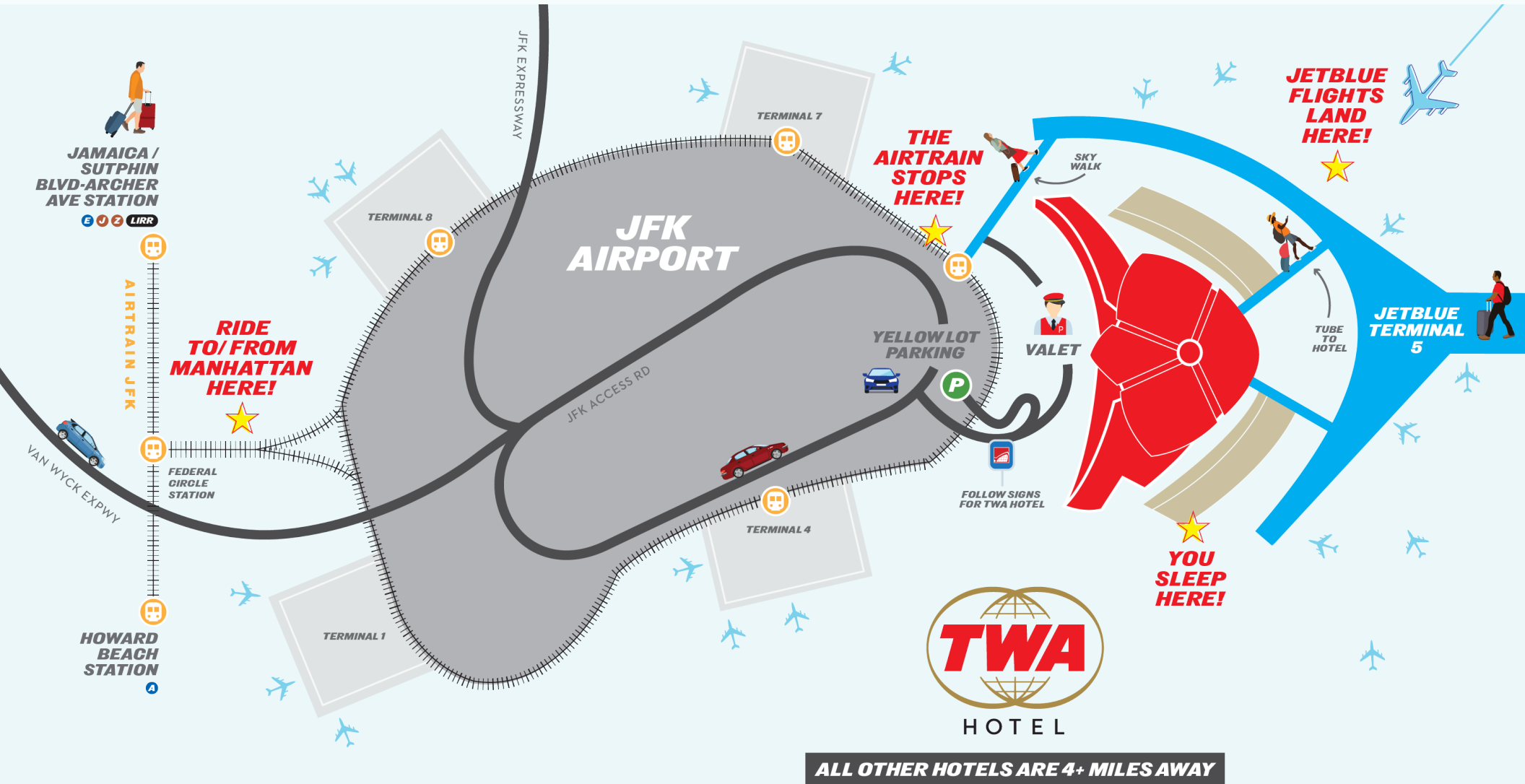

“It seems to offer the visitor nothing but choices, to go up the wide central stairs ... to settle into the sun-drenched Sunken Lounge or wind your way up to the restaurants and bars above, to move or to sit, to explore or to dream.”

— THE WASHINGTON POST

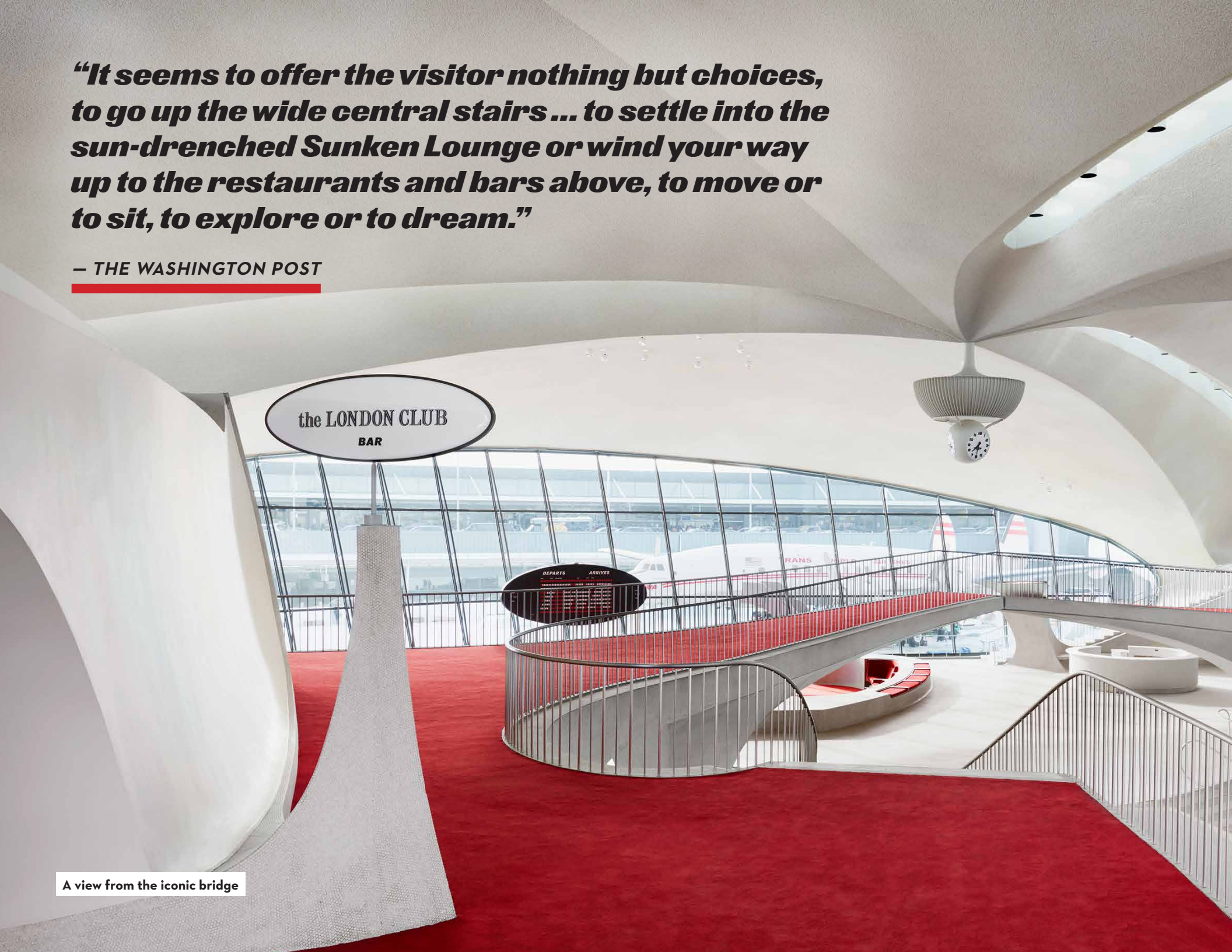

A view from the iconic bridge

The Historic TWA Flight Center

Fully restored to its original glory, the TWA Flight Center offers 200,000 square feet of flexible space including outdoor terraces. Original details – the Vulcain clock, sparkling white penny tile and plush Chili Pepper Red carpets – exude Jet Age glamour. Saarinen’s iconic Flight Tubes (made famous by the 2002 film *Catch Me If You Can*) lead to guestrooms and museum exhibits, as well as provide a premium photo opp! The nostalgic clacking sound of two authentic Solari split-flap boards – and the view of the 1958 Lockheed Constellation on the tarmac just outside – transport visitors back to the golden age of travel.



A flight tube



Office of Howard Hughes exhibit



Bridgeway overlooking The Sunken Lounge

Event Center

Stairway to Event Center



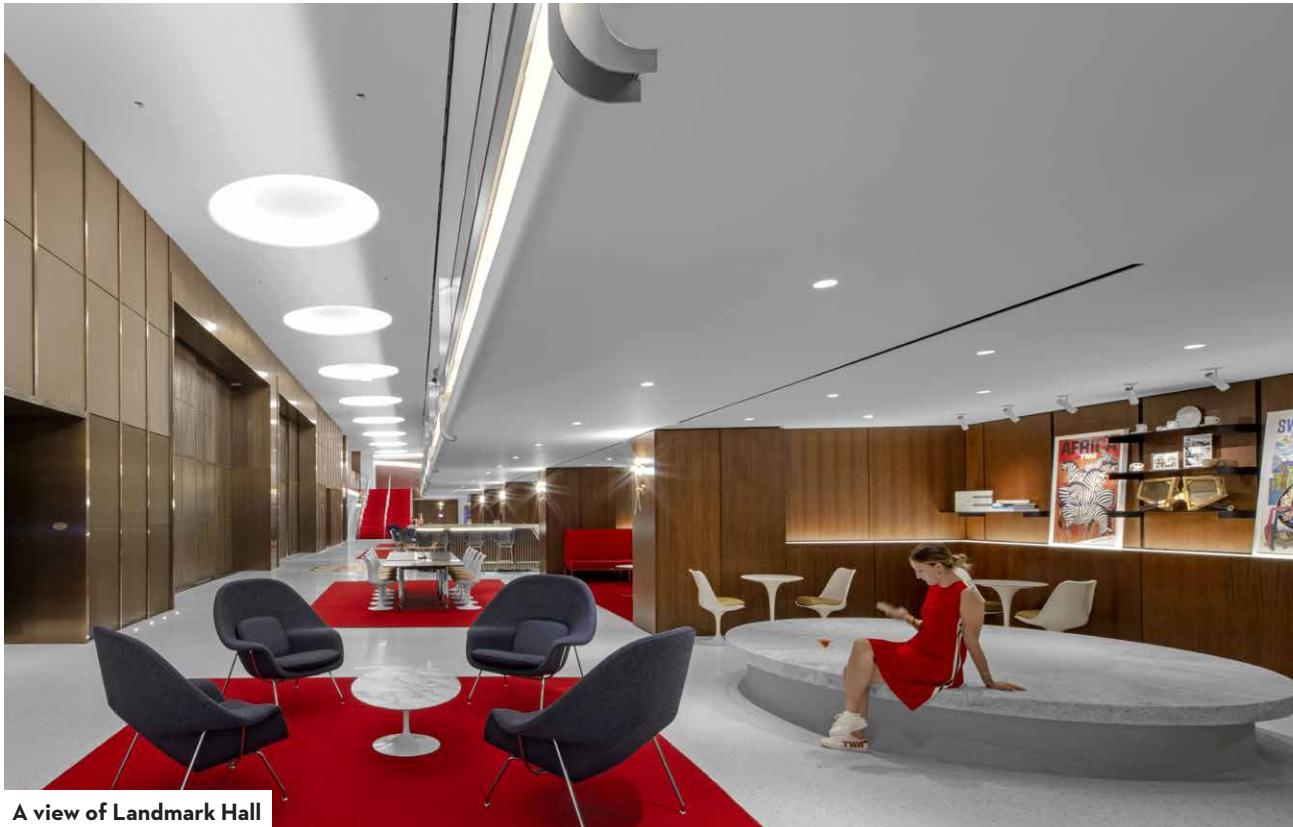

A view of Landmark Hall

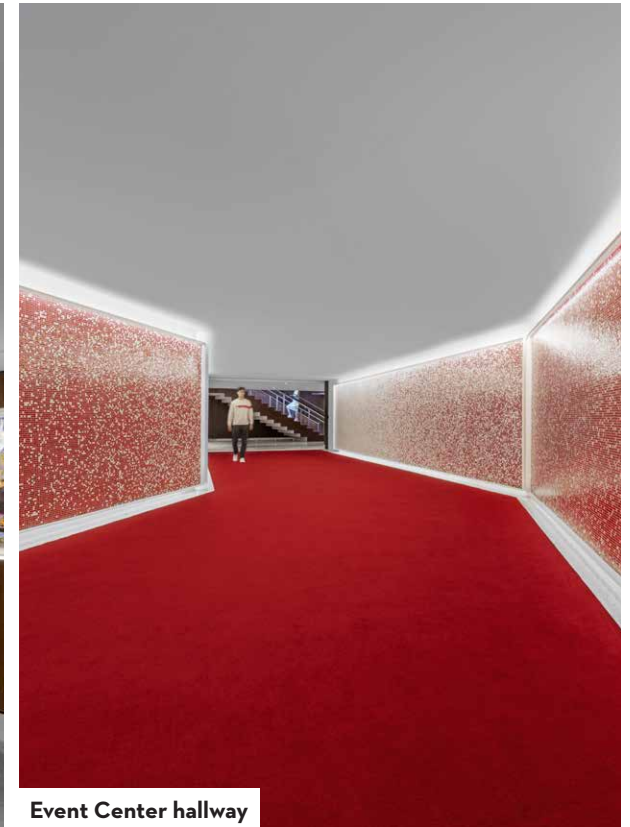

Event Center hallway

Event Center

- 50,000 square feet of midcentury modern-inspired event space
- Accommodates up to 1,600 people
- 45 flexible event rooms
- 11,000-square-foot Constellation Ballroom, including Landmark Hall pre-function space
- Kosher kitchen
- Custom food and beverage from cocktails to four-course dinners; plus the option of third-party catering
- Audiovisual and teleconferencing equipment overseen by onsite experts
- Dedicated onsite event planners and day-of support

Event Center

Upper Level

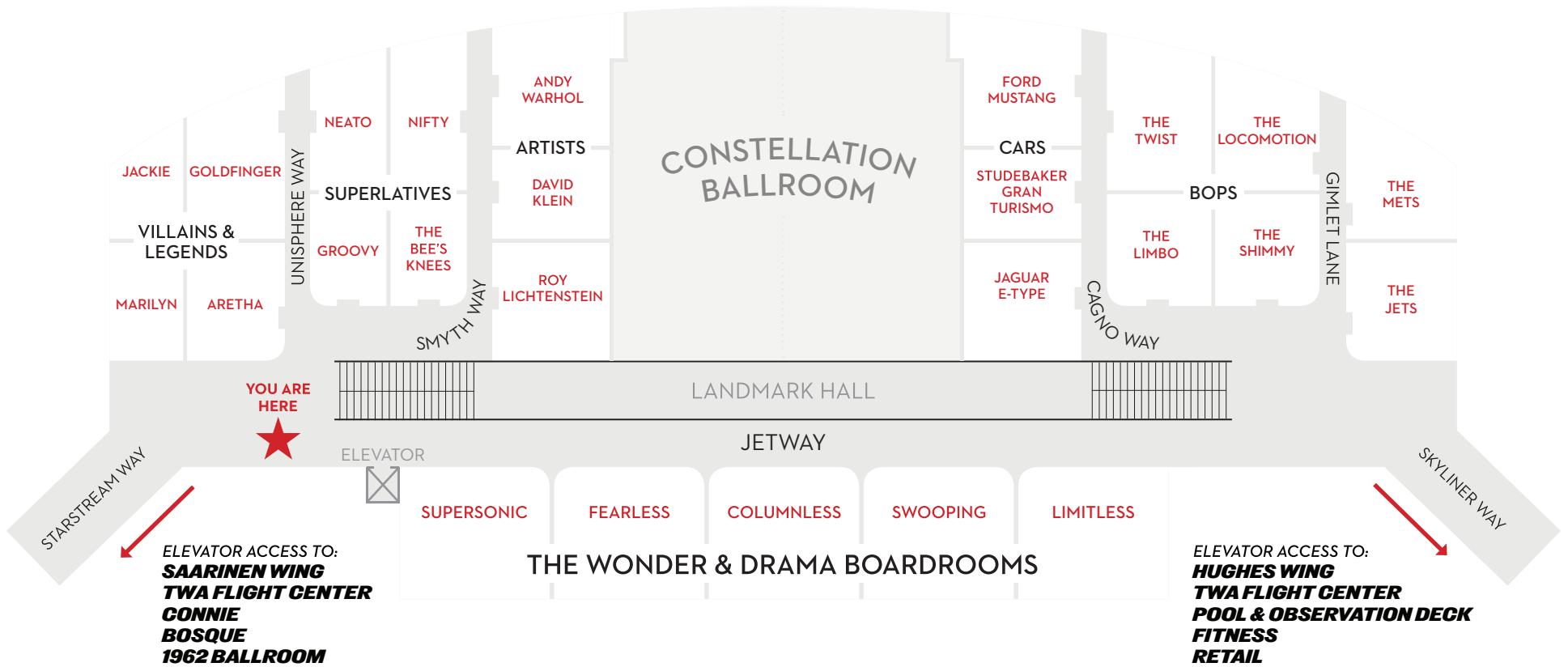

Event Center

Upper Level Event Space	Sq. Ft.	Theater	Classroom	Conference	U-Shape	Full Rounds	Half Rounds	Reception
Villains & Legends Quad	902	90	40	32	25	60	42	100
Jackie	223	20	14	14	10	12	7	25
Goldfinger	208	20	12	12	8	10	7	25
Aretha	223	20	14	14	10	12	7	25
Marilyn	223	20	14	14	10	12	7	25
Superlatives Quad	882	85	35	28	24	60	42	95
Neato	212	20	12	12	8	10	7	25
Nifty	212	20	12	12	8	10	7	25
The Bee's Knees	230	20	14	14	10	12	7	25
Groovy	185	16	-	12	8	10	-	-
Artists Skyboxes								
Andy Warhol	244	-	-	10	8	10	-	-
David Klein	263	-	-	12	10	10	-	-
Roy Lichtenstein	232	-	-	10	8	10	-	-
Cars Skyboxes								
Ford Mustang	243	-	-	10	8	10	-	-
Studebaker Gran Turismo	262	-	-	12	10	10	-	-
Jaguar E-Type	231	-	-	10	8	10	-	-
The Bops Quad	1007	95	40	35	28	70	49	100
The Twist	245	24	16	16	10	20	14	25
The Locomotion	241	24	16	16	10	20	14	25
The Shimmy	257	24	16	16	12	20	14	25
The Limbo	264	24	16	16	12	20	14	25
The Mets Room	254	30	20	25	10	20	14	30
The Jets Room	254	30	20	25	10	20	14	30
The Wonder & Drama Boardrooms								
Supersonic	249	-	-	10	8	-	-	-
Fearless	250	-	-	10	8	-	-	-
Columnless	250	-	-	10	8	-	-	-
Swooping	250	-	-	10	8	-	-	-
Limitless	270	-	-	10	8	-	-	-

Event Center

Lower Level

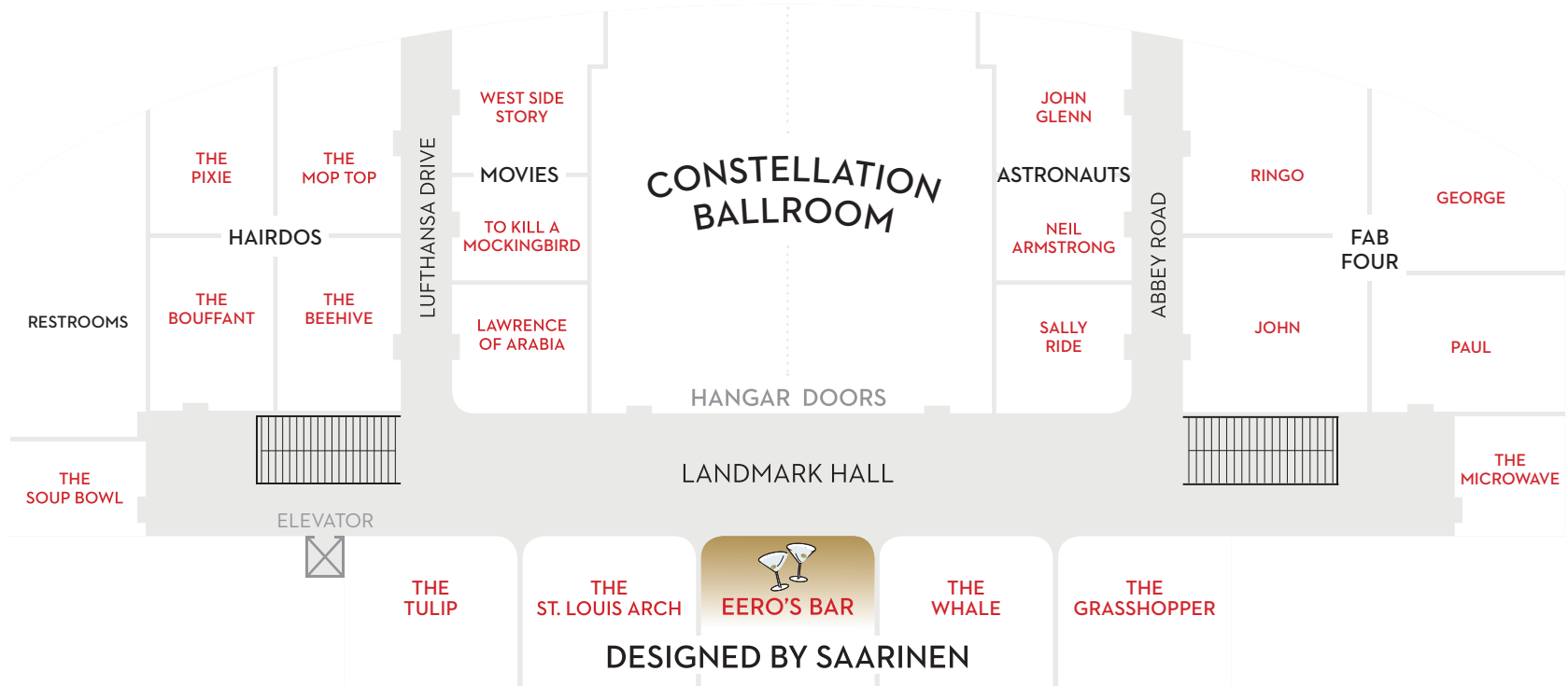

Event Center

Lower Level Event Space	Sq. Ft.	Theater	Classroom	Conference	U-Shape	Full Rounds	Half Rounds	Reception
Constellation Ballroom Entire	6,006	950	300	-	80	450	325	1,200
Constellation AB	4,872	696	250	-	75	370	220	1,000
Constellation A	2,436	348	125	-	45	160	110	500
Constellation B	2,436	348	125	-	45	160	110	500
Constellation A + Movies	3,003	425	150	-	50	200	140	600
Constellation B + Astronauts	3,003	425	150	-	50	200	140	600
Movies Trio	567	48	-	24	-	30	-	40
West Side Story	182	16	-	12	8	10	-	-
To Kill a Mockingbird	200	16	-	12	8	10	-	-
Lawrence of Arabia	185	16	-	12	8	10	-	-
Astronauts Trio	567	48	-	24	-	30	-	40
John Glenn	182	16	-	12	8	10	-	-
Neil Armstrong	200	16	-	12	8	10	-	-
Sally Ride	185	16	-	12	8	10	-	-
Hairdos Quad	1140	110	50	44	30	90	48	120
The Pixie	264	30	10	14	10	20	14	30
The Mop Top	325	35	15	18	20	30	21	40
The Beehive	276	30	10	14	10	20	14	30
The Bouffant	275	30	15	14	10	20	14	30
The Soup Bowl	301	40	16	12	10	30	14	50
The Fab Four Quad	1278	110	55	45	35	90	48	120
Ringo	370	40	20	20	22	30	21	40
George	324	30	20	15	10	20	14	30
Paul	288	30	20	15	10	20	14	30
John	292	30	20	18	10	20	14	30
The Microwave	122	-	-	6	-	-	-	-

Landmark Hall

Guests can enjoy a cocktail at Eero's Bar and mingle in the 5,200-square-foot Landmark Hall pre-function space just outside the Constellation Ballroom. Authentic Saarinen-designed Knoll furniture – including Pedestal tulip tables and comfy Womb chairs – provide stylish spaces for attendees to relax, while curated vignettes of retro TWA artifacts serve as surefire conversation-starters.

- **Reception:** 500 guests
- **Rounds of 10:** 220 guests



Landmark Hall

Constellation Ballroom

The 6,000-square-foot Constellation Ballroom – ideal for galas, trade shows, conferences, cultural events and more – boasts soaring 21-foot ceilings. Divisible in half, the room connects with 5,200 square feet of pre-function space. Unique floor-to-ceiling hangar doors provide the opportunity for a dramatic “reveal” of the space to guests. Six Skyboxes overlooking the ballroom can be used for audio/visual needs, pre-event prep or balcony-like views of the room.

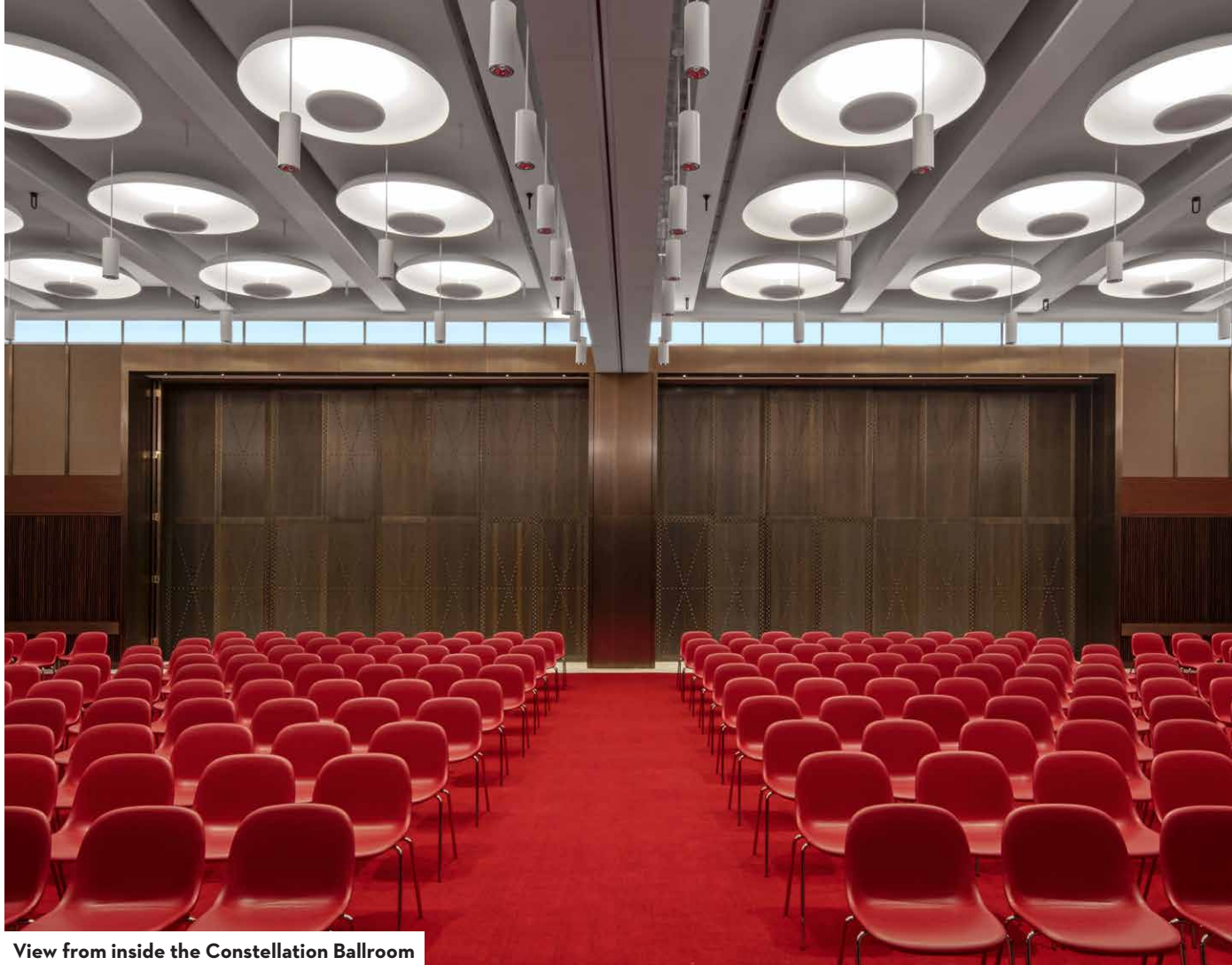

View from inside the Constellation Ballroom

Event Space	Sq. Ft.	Theater	Classroom	U-Shape	Full Rounds	Half Rounds	Reception
Constellation Ballroom Entire	6,006	950	300	80	450	325	1,200
Constellation AB	4,872	696	250	75	370	220	1,000
Constellation A	2,436	348	125	45	160	110	500
Constellation B	2,436	348	125	45	160	110	500
Constellation A + Movies	3,003	425	150	50	200	140	600
Constellation B + Astronauts	3,003	425	150	50	200	140	600
Constellation Entire + Artists + Cars	7,481	1,070	-	-	530	-	1,320

Constellation Ballroom & Landmark Hall Exhibitions

When combined, the Constellation Ballroom and Landmark Hall offer more than 11,000 square feet of flexible exhibition space that accommodates up to 125 tabletops and 55 8x10 booths – by far the largest exhibition venue in the area.

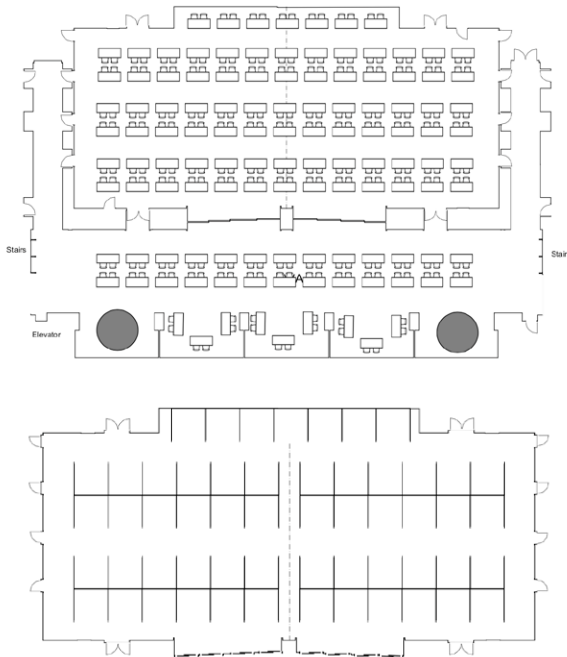

The Constellation Ballroom

Event Space	Sq. Ft.	Tabletops	8x10s
Constellation Entire	6,006	85	55
Constellation AB	4,872	70	46
Constellation A	2,436	34	23
Constellation B	2,436	34	23
Constellation A + Movies	3,003	40	27
Constellation B + Astronauts	3,003	40	27
Constellation Entire + Landmark Hall	11,241	125	55
Landmark Hall	5,235	35	0

Small Meeting Rooms & Skyboxes

Among the 45 event rooms are six Skyboxes overlooking the Constellation Ballroom and boardrooms that can accommodate parties of various sizes, some of which can be divided into smaller spaces as needed. Technology experts are on site to connect audiovisual and teleconferencing equipment, all powered by 5GB of super fast Wi-Fi speed.

- **Theater:** 80-100 guests
- **Classroom:** 40-55 guests
- **Conference:** 15-40 guests
- **U-Shape:** 10-30 guests
- **Half Rounds:** 15-40 guests
- **Reception:** 40-120 guests

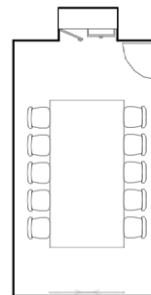
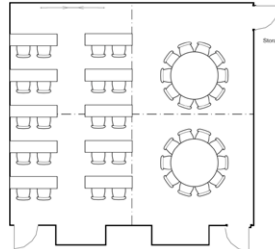
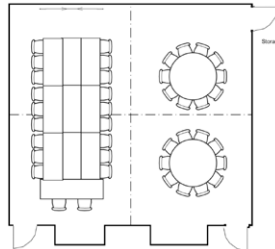
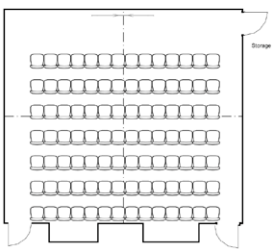

Meeting room



Meeting room



The 1962 Ballroom

The 1962 Room

Looking out onto the former TWA terminal, this 4,200-square-foot landmarked ballroom with 15-foot ceilings rolls out the red carpet for corporate meetings, power lunches and events of all kinds. Marked by natural light and retro penny tile flooring, the space offers guests the convenience of immediate access to the hotel's Arrivals Hall and Idlewild Drive.

- **Theater:** 325 guests
- **Classroom:** 150 guests
- **U-Shape:** 50 guests
- **Full Rounds:** 220 guests
- **Half Rounds:** 150 guests
- **Reception:** 450 guests

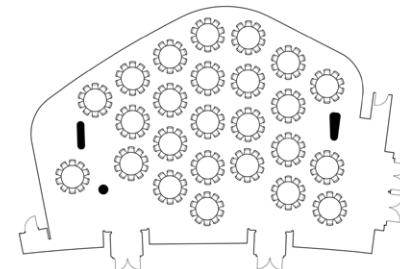
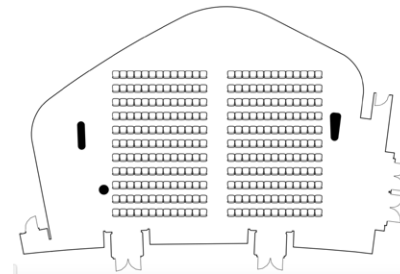

***“There’s surely no more stylish
way to unwind at JFK.”***

– INTERIOR DESIGN MAGAZINE

Specialty Venues



A view from the bridgeway

The Sunken Lounge

In 1965, crowds gathered on these penny-tiled banquettes to watch the Beatles arrive in the United States. These days, the TWA Hotel's signature bar serves up the best martinis for miles, in addition to custom cocktails. Floor-to-ceiling windows provide guests breathtaking views of the 1958 Lockheed Constellation "Connie" airplane parked on the tarmac just outside. Meanwhile, an authentic split flap Solari board displays messages that can be customized for events.

- **Reception:** 220 guests (inside The Sunken Lounge only)

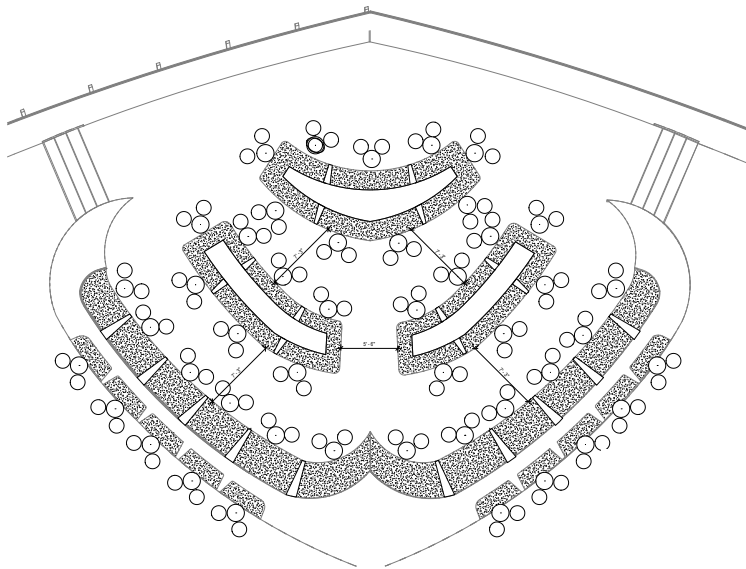

The Sunken Lounge

Paris Café & Lisbon Lounge

Bon appétit! Celebrated chef Jean-Georges Vongerichten oversees the historic Paris Café and its sleek bar area, the Lisbon Lounge. Located in the heart of the TWA terminal, the spaces were originally outfitted by famed Parisian industrial designer Raymond Loewy – the mind behind the airline's twin globes logo. The café serves breakfast, lunch and dinner. Guests can indulge in Vongerichten's famed black truffle pizza while watching planes take off through the floor-to-ceiling windows.

- **Reception:** 150 guests

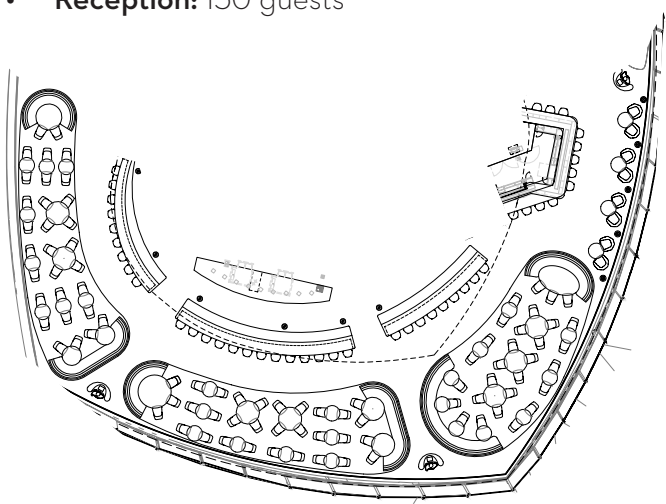

Semi-private dining for between 8-30 guests can be accommodated in certain sections.

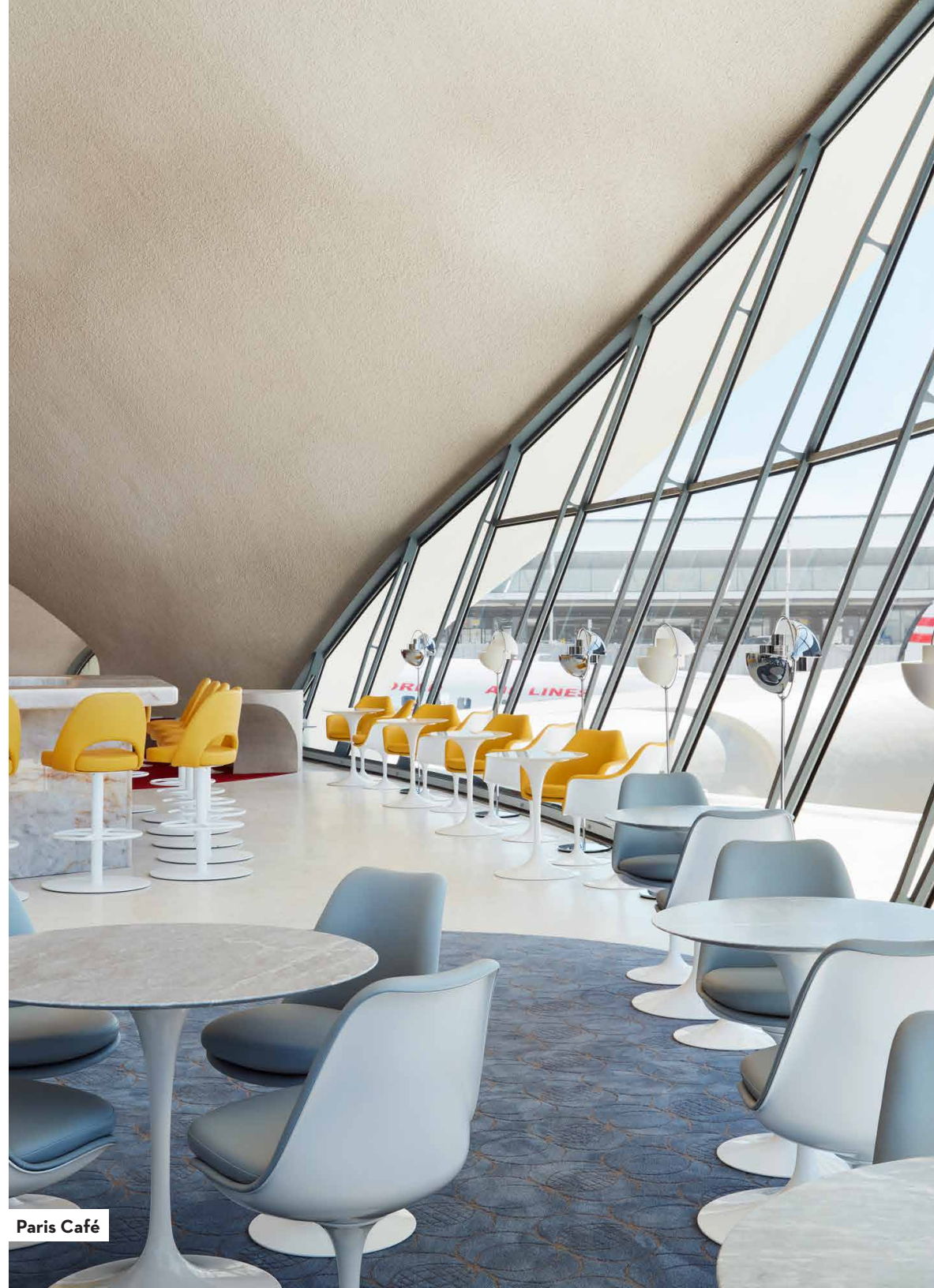

Connie Cocktail Lounge

Connie, an original 1958 Lockheed Constellation airplane, offers a one-of-a-kind cocktail lounge experience. Her smartly renovated cabin – where vintage-inspired drinks and nibbles are served – accommodates 75 guests and provides a first-class setting for VIP gatherings. (The space can also be included as part of a larger-scale event package.) Want to take it to the tarmac? Connie's runway can host upwards of 2,000 people.

TARMAC

- **Reception:** 2,000 guests
- **Full Rounds:** 1,000 guests
- **Theater:** 1,500 guests

CONNIE

- **Reception:** 75 guests

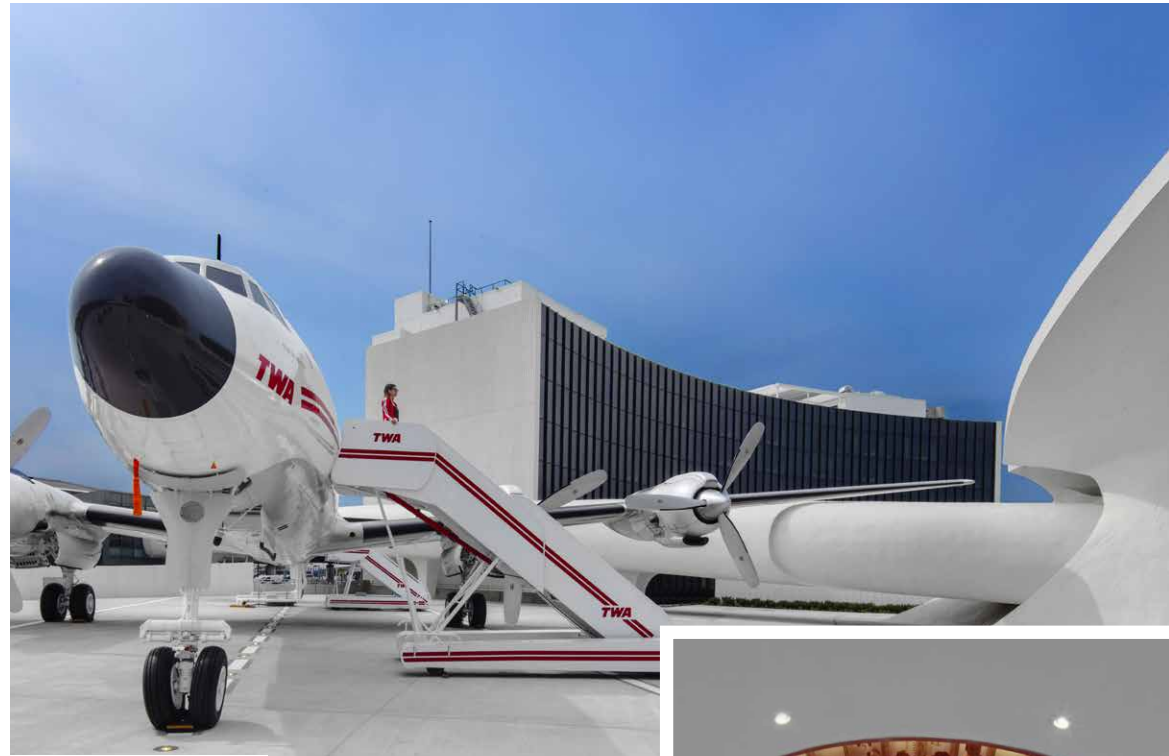
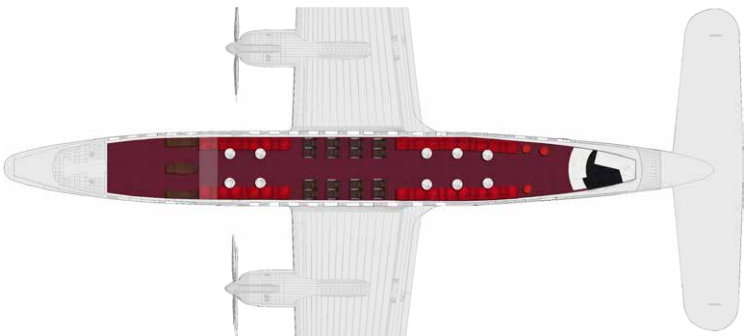

Connie cocktail lounge



Seating on the Connie (@voguishsoul)



Connie's cabin

The Pool Bar & Observation Deck

Inspired by the Hotel du Cap-Eden-Roc in Cap d'Antibes, France, our heated infinity pool and observation deck overlooks JFK's bustling Runway 4 Left/22 Right, with views all the way to Jamaica Bay. Open year-round, the showstopping space features the full-service Pool Bar and room for 200 guests.

- **Reception:** 200 guests
- **Existing Seating:** 120 guests



The Pool Bar & Observation Deck



An Aqualillies water ballet performance

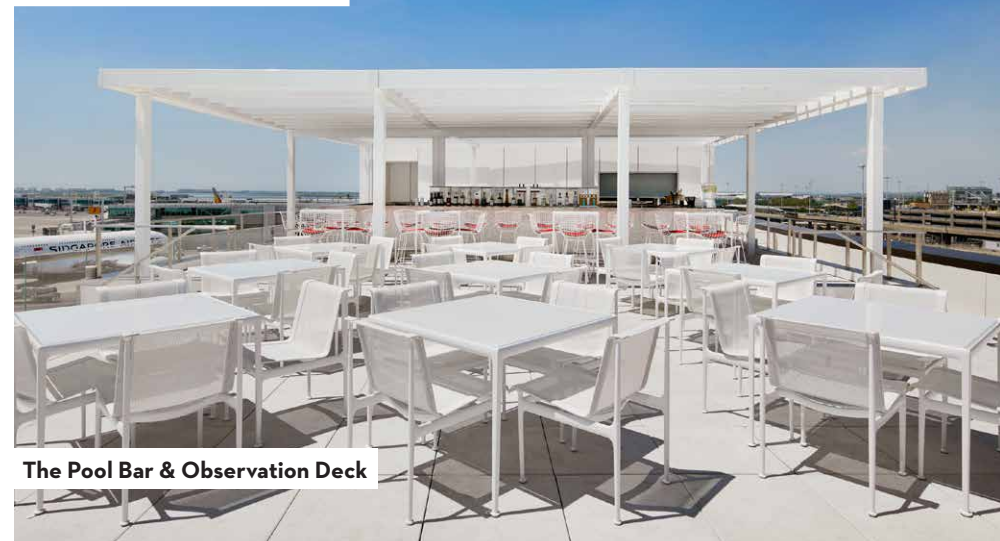

The Pool Bar & Observation Deck



Louis Vuitton Cruise 2020 fashion show



TWA Hotel grand opening celebration



Open House New York reception

***“It’s a sanctuary that’s been
revived and seeing it enchant anew...
is a great pleasure.”***

**– NICOLAS GHESQUIÈRE,
CREATIVE DIRECTOR, LOUIS VUITTON**



“We fell head over heels in love with the futuristic design.”

— ADRIANA, TWA HOTEL BRIDE



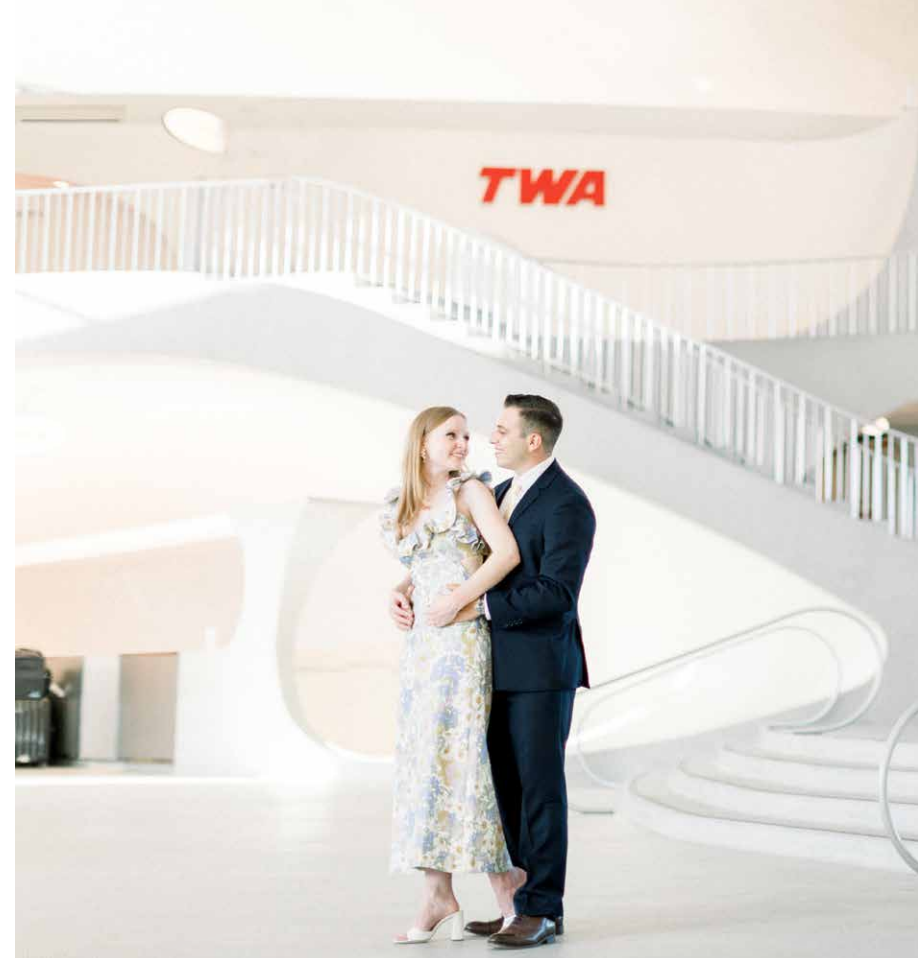

“There truly is nothing else like it. The size and scale of the terminal, with its vaulted ceilings and sweeping staircases, is so different from anything else in New York.”

**— LAUREN SCHAEFER,
THE GET TOGETHER EVENTS CO.**

FADE TO BLACK
NEW YORK

Guestrooms



Howard Hughes Presidential Suite

Our 512 guestrooms invite guests to settle into a classic Knoll womb chair and relax. Rooms boast enviable views of the historic Flight Center or JFK's runways, while the world's second-thickest glass curtain wall ensures planes are seen but never heard.

- **Floor-to-ceiling windows** for optimum views
- Lightning fast 5GB Wi-Fi
- **Luxurious bedding** and ultra-comfortable Sealy mattress
- Automated full blackout shades
- Samsung 50-60-inch television
- **Retrofitted vintage Western Electric 500 rotary phone**
- Authentic midcentury Knoll furnishings and **vintage David Klein TWA poster art**
- Gleaming terrazzo-tiled bathroom with **Hollywood-style vanity**
- Custom cedar-scented bath amenities, hair dryer and steamer
- **Wireless Smartphone charger** with two USB ports for powering three compatible devices at once

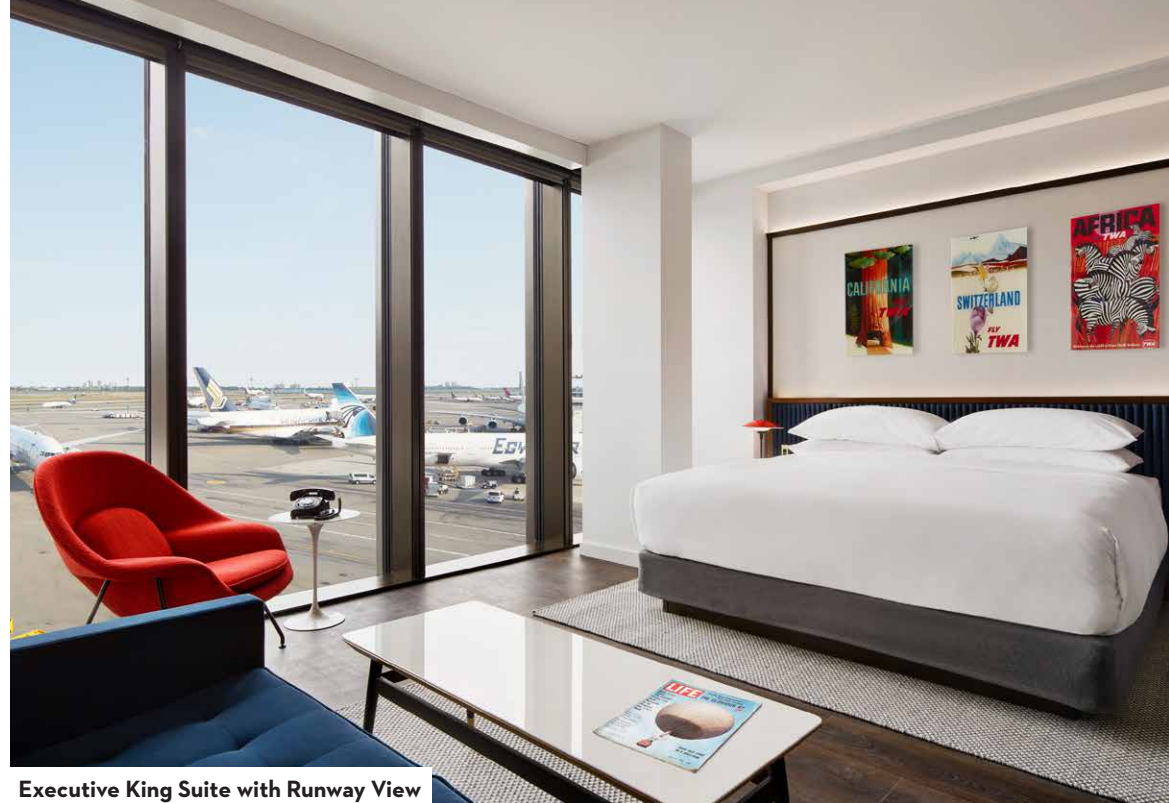

Executive King Suite with Runway View



Guestroom bedside area

Guestroom Category	Total	Historic TWA Flight Center View	Runway View
King Bed	317	101	25
Two Double Queen Beds	153	82	23
Executive King Suite	35	22	3
Executive Two Double Queen Suite	5	0	5
Presidential	2	1	1
Totals	512	206	57

Amenities



The TWA Flight Center

TWA Fitness

At 10,000 square feet, TWA Fitness is the world's largest hotel gym. Open 24/7, the gym offers:

- A cycling studio with 14 Peloton bikes
- A full yoga studio
- 12 treadmills
- 10 ellipticals
- Free weights
- Personal training
- Group classes
- Extra large lockers
- Changing rooms stocked with supplies and featuring Hollywood-style vanities

Access is included with hotel stay; day passes are available for non-guests.



Weights and medicine balls at TWA Fitness



Treadmills, weight machines and more at TWA Fitness

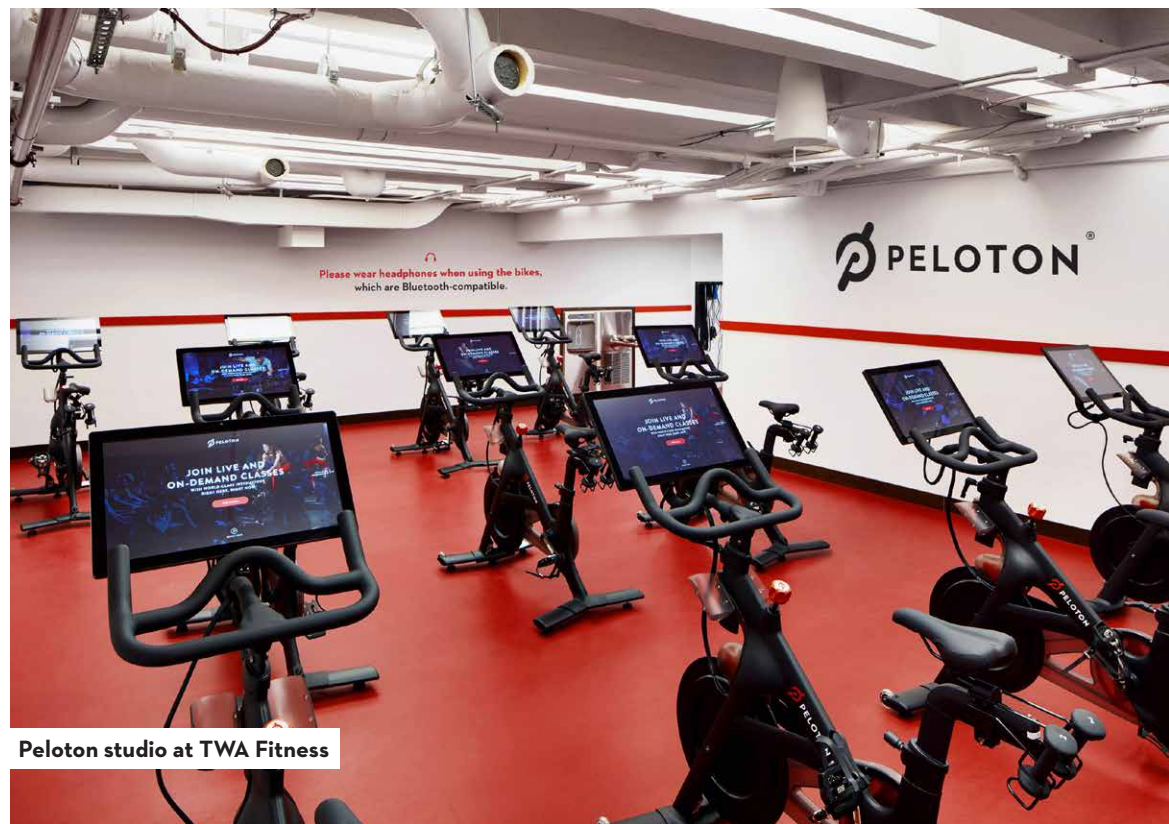

Peloton studio at TWA Fitness

The TWA Shop

Pretty fly party favors! The TWA Shop offers exclusive branded merchandise – including apparel, accessories and housewares – from its store at the hotel and online. Our team can help you choose the ideal items to complement your event and delight guests.



Patches and more at The TWA Shop



Custom Musgrave pencils at The TWA Shop



Exclusive TWA apparel

Food & Beverage



Food Hall

Grab and go – or sit and stay awhile! Vendors offer fresh bagels, salads, sandwiches, snacks and assorted beverages all day in the hotel's Food Hall.

Helicopter Transportation



BLADE

West side of Manhattan to JFK in five minutes? Make it happen for your guests with BLADE helicopter service to and from your event. Prices start at \$195 per seat; group rates are available.

Blade helicopters fly to JFK.

Custom Extra



The Solari board in The Sunken Lounge



Solari Board

Our split-flap departures board by Italy's Solari di Udine can display personal messages and large-scale graphics. Choose from a template or work with our team to design your own!

Awards

Iconic Project
NYC x Design Awards

Global Tastemakers Awards,
The Best Hotel Bars and The Best
Hotels for Food in the U.S.
Food & Wine

Readers' Choice Awards
Condé Nast Traveler

It List
Travel + Leisure

Innovation by Design Award
Fast Company

Lucy G. Moses Preservation Award
The New York Landmarks Conservancy

Outstanding Design of Alternative Eating and
Drinking Places Nominee (Connie)
James Beard Foundation Awards

Legend Awards:
Best Hotel Bars in the World (Connie)
Departures

Best Game-Changer
Jetsetter

Best Hotel, Bar/Lounge (Connie) and
Commercial Lobby/Amenity Space
NYC x Design Awards

Excellence in Hotel Development Award
ULI New York

Best Hospitality Transformation
Interior Design Magazine

Best Adaptive Reuse
MAStErworks Awards

Best Hotel & Tourism Resort Finalist
MIPIM Awards

Development of the Year (Full Service)
The ALIS Awards

World's Greatest Places
TIME Magazine

Best Architecture
The Wall Street Journal

100 Reasons to Love America
People Magazine

Best Hotel Opening
Forbes

Best New Hotel
Time Out New York

30 Best Places to Instagram
ELLE

Best Reason to Take a Staycation
Curbed New York

New York State Historic Preservation Award
**New York State Office of Parks,
Recreation and Historic Preservation**

HD Awards for Public Space and Restorations
and Transformations & Conversions
Hospitality Design

Distinguished Achievement Awards; Best
Design, Gold, and Best Development, Gold
Commercial Property Executive

Best Guestroom, Upper Midscale
and Judges' So Cool
Boutique Design Gold Key Awards

Building of the Year, Adaptive Reuse
The Architect's Newspaper

Building Awards for New Construction,
Hotels & Motels, Rehabilitation/Adaptive
Reuse and Open or Enclosed Public Space
Queens Chamber of Commerce

Restaurant & Bar Design Awards Shortlist
(The Paris Café and Connie)
Restaurant & Bar Design Awards

For a tour of the TWA Hotel or more information,
please contact events@twahotel.com

TWAhotel.com